

# River Park Plan

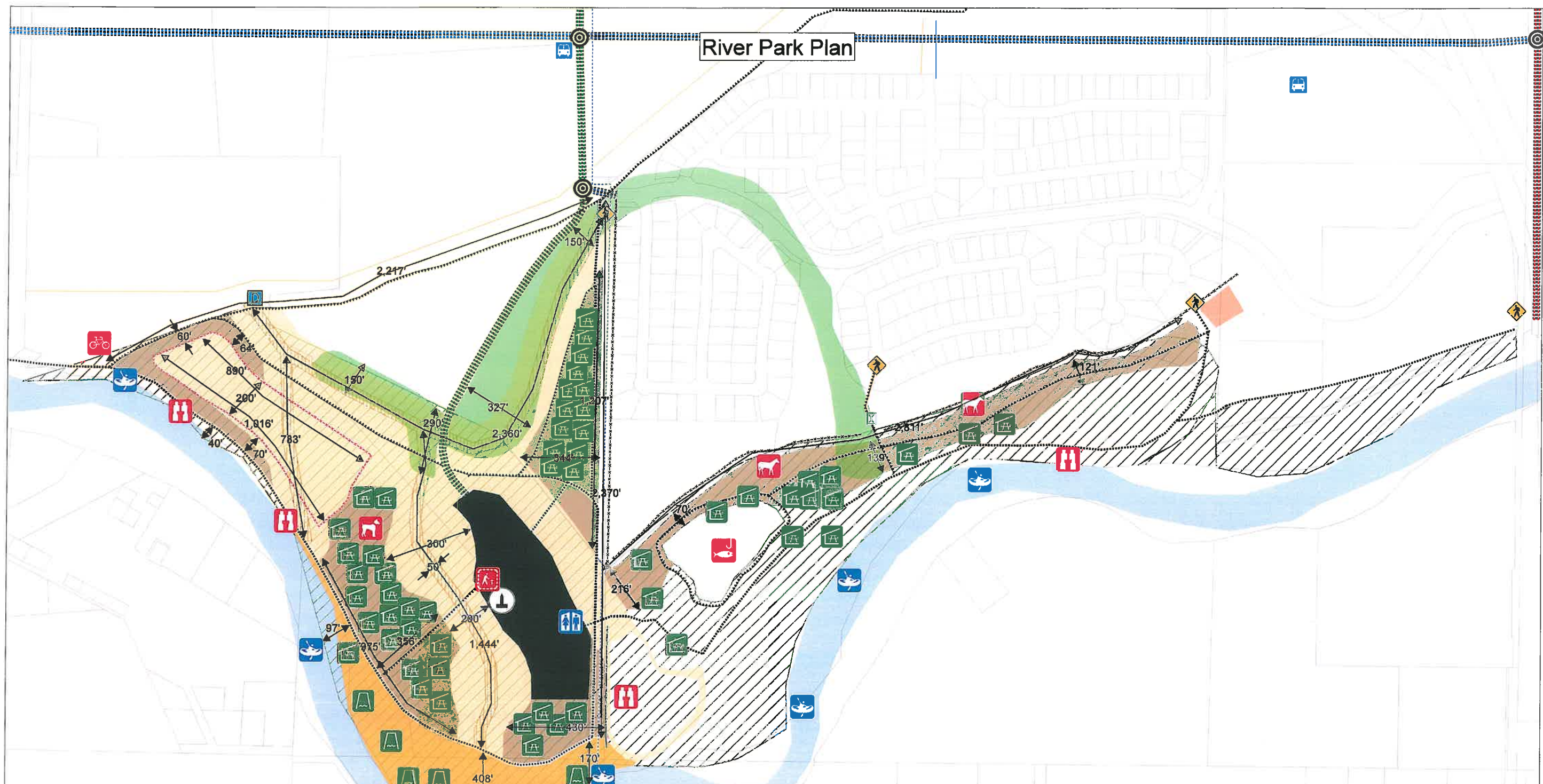

## EXPLANATION

- |   |  |   |
|---|--|---|
| <ul style="list-style-type: none"> <li>Align Middleton Rd (Est. Const. 2022)</li> <li>Cemetery Rd (Est. Const. 2021)</li> <li>River St (Est. Const. 2020)</li> <li>Emmett Rd (Future)</li> <li>Bridge (Future)</li> <li>Pedestrian Bridge (Future)</li> <li>River St/Middleton Rd RAB (Est. Const. 2019)</li> <li>River St/Cemetery Rd RAB (Est. Const. 2022)</li> <li>River St/Emmett Rd (Future)</li> <li>Floodplain Maintenance Staging Area</li> <li>138 kV Power Transmission Line (Est. Const. 2019)</li> <li>Water Main (Existing)</li> <li>Water Main (Future)</li> <li>Sewer Main (Existing)</li> <li>Sewer Service Line (Future)</li> <li>Parking Permeable Pavers (Future)</li> <li>Boise River</li> </ul> | <ul style="list-style-type: none"> <li>Mill Slough Sediment Basin Gate (Est. Const. 2017)</li> <li>Shelter and Picnic Table (Future)</li> <li>Swing (Future)</li> <li>Float Take-Out (Future)</li> <li>Pathway-Trailhead (Future)</li> <li>Veterans Memorial (Future)</li> <li>Bike Repair/Water Bottle Fill Station (Future)</li> <li>Radio Control Airplane Park (Future)</li> <li>Educational Nature Path (Future)</li> <li>Fishing Pond (Future)</li> <li>Equestrian Trails (Future)</li> <li>Dog Park (Future)</li> </ul> | <ul style="list-style-type: none"> <li>Road (Future)</li> <li>Fence</li> <li>Fence - Reuse Pilot Test Area</li> <li>Water Quality Natural Drainage</li> <li>Water Quality Fringe</li> <li>Water Quality Wetlands</li> <li>Riparian Area</li> <li>Wildlife Habitat Areas</li> <li>12' Wide Greenbelt Paved (Future)</li> <li>12' Trail Unpaved (Future)</li> <li>Observation Berm</li> <li>Water Recreation</li> <li>Vista</li> <li>Transit Station (Future)</li> <li>Restroom and Drinking Fountain (Future)</li> <li>RV Dump Station (Existing)</li> </ul> |
|---|--|---|

Revision Date: 2018-12-20